

ROMAN SHADE STANDARD CORDLESS

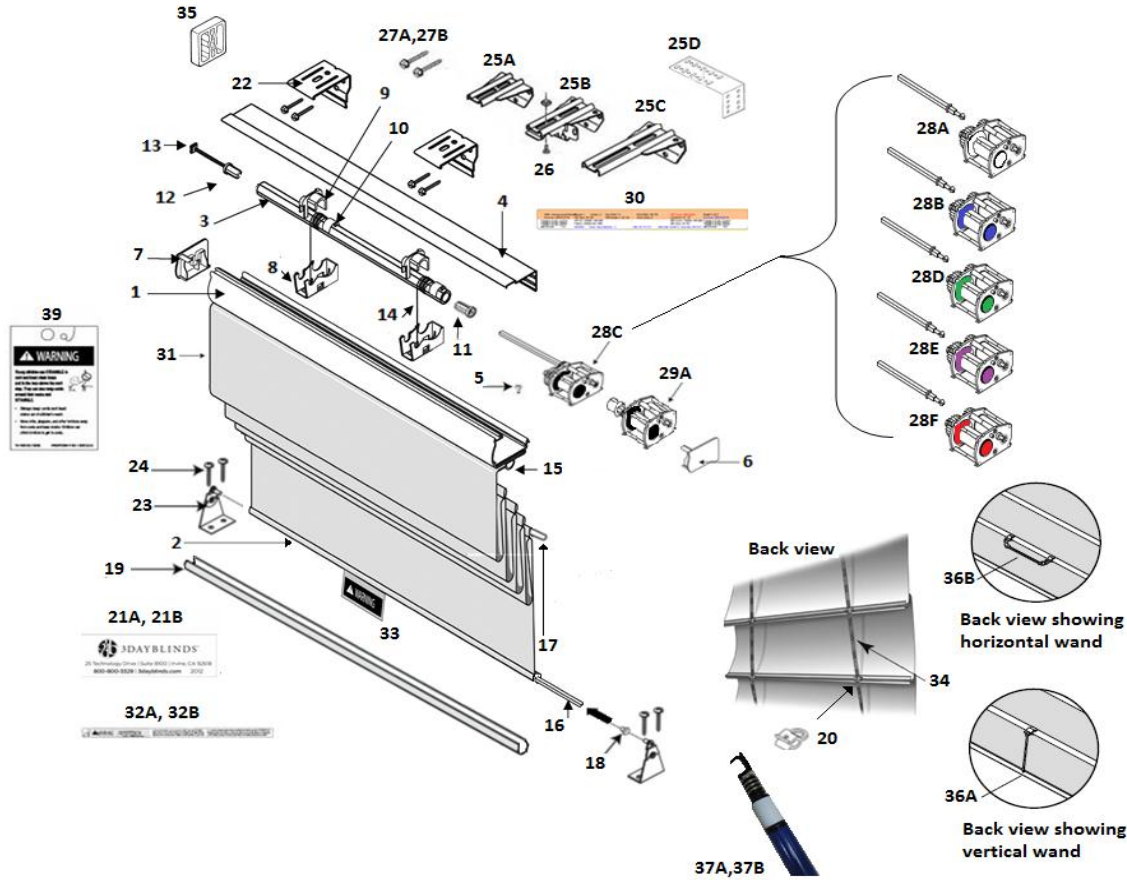

| | | | | | |
|------|----------------------------|---------------|------|---------------------------------|---------------|
| 1. | HEADRAIL CCL/ CORDLESS | 03031-XXX-000 | 25A. | * PROJECTION BRACKET 2" | 17302-000-000 |
| 2. | HEMRAIL ALUMINUM | 17101-000-192 | 25B. | * PROJECTION BRACKET 2 5/8" | 17303-000-000 |
| 3. | ALUMINUM TUBE | 03027-037-000 | 25C. | * PROJECTION BRACKET 3 1/2" | 17304-000-000 |
| 4. | DUST COVER | 03027-036-000 | 25D. | * EXTENSION BRACKET | 06231-000-000 |
| 5. | HEADRAIL SCREW #6-31x1/4" | 03027-001-000 | 26. | NUT AND BOLT SET | 17403-000-000 |
| 6. | HEADRAIL END CAP - RIGHT | 03033-XXX-000 | 27A. | * BAGGED SCREWS #6 x 1 1/4" | 17400-000-000 |
| 7. | HEADRAIL END CAP - LEFT | 03034-XXX-000 | 27B. | * 2" #8 PHILLIPS HEX HEAD SCREW | 08756-000-000 |
| 8. | CRADLE | 03027-033-000 | 28A. | ** MOTOR RIGHT SIDE - WHITE | 17115-000-000 |
| 9. | CRADLE COVER | 03027-027-000 | 28B. | ** MOTOR RIGHT SIDE - BLUE | 03027-009-000 |
| 10. | STEEL CORD CLIP | 03027-035-000 | 28C. | ** MOTOR RIGHT SIDE - BLACK | 03027-010-000 |
| 11. | DRIVE PLUG | 03027-026-000 | 28D. | ** MOTOR RIGHT SIDE - GREEN | 03027-011-000 |
| 12. | THREADED END PLUG | 03027-034-000 | 28E. | ** MOTOR RIGHT SIDE - GRAPE | 03027-012-000 |
| 13. | THREADED ROD | 03027-038-000 | 28F. | ** MOTOR RIGHT SIDE - RED | 03027-013-000 |
| 14. | LIFT CORD (0.9mm w/FILLER) | 06190-100-000 | 29A. | ** ASSIST MOTOR RIGHT- BLACK | 03027-015-000 |
| 15. | PVC INSERT SLAT | 17104-000-000 | 30. | WHITE JOB TICKET | 00005-028-000 |
| 16. | TILT ROD | 08621-000-000 | 31. | FABRIC | VARIES |
| 17. | .129" FIBERGLASS ROD | 17105-000-000 | 32A. | * LABEL - CHILD SAFETY LONG | 00002-111-000 |
| 18. | HEMRAIL END PLUG | 17103-000-000 | 32B. | * LABEL - CHILD SAFETY SHORT | 00002-113-000 |
| 19. | HEMRAIL COVER | 17102-000-000 | 33. | TAG-INNER CORD STOP WARNING | 00002-201-000 |
| 20. | FLAT ROMAN CLIP | 17408-000-000 | 34. | CORD SHROUD | 17000-XXX-001 |
| 21A. | * 3 DAY BLIND LOGO BLACK | 00002-112-000 | 35. | 3/8" MOUNTING SPACER | 01680-000-000 |
| 21B. | * 3 DAY BLIND LOGO WHITE | 00002-114-000 | 36A. | VERTICAL CORDLESS HANDLE | 17012-001-000 |
| 22. | MOUNTING BRACKET | 03027-041-000 | 36B. | HORIZONTAL CORDLESS HANDLE | 17012-002-000 |
| 23. | HOLD DOWN BRACKET | 01672-000-000 | 37A. | 6 FT EXTENSION POLE CORDLESS | 03851-000-072 |
| 24. | HOLD DOWN BRACKET SCREW | 05971-000-000 | 37B. | 12 FT EXTENSION POLE CORDLESS | 03851-000-144 |

* AS REQUIRED (A OR B OR C)

** AS REQUIRED (ANY COMBINATION A,B,C,D AND E)